

# Motor Mob

ASESORANDO INDUSTRIAS

- Motores Eléctricos - Motorreductores
- Bombas Centrífugas y Autocebantes
- Bombas para Presurización y Calefacción
- Bombas para Desagote y Sumergibles
- Válvulas y Accesorios
- Bobinados - Reparaciones
- Sellos Mecánicos - Repuestos
- Ventilación Industrial
- Montajes Industriales

Tel.: (54-011) 4753-2348

Av. 101 (Ruta 8) N° 1882 - San Martín - Pcia. de Bs. As. - Argentina

PAGINA WEB: [www.electromecanicamm.com.ar](http://www.electromecanicamm.com.ar)

E-MAIL: [electromecanicamm@hotmail.com](mailto:electromecanicamm@hotmail.com)

**KPA**  
SELF-PRIMING PERIPHERAL PUMPS

**DOMESTIC WATER SUPPLY**

ENERGY EFFICIENCY **IE2**

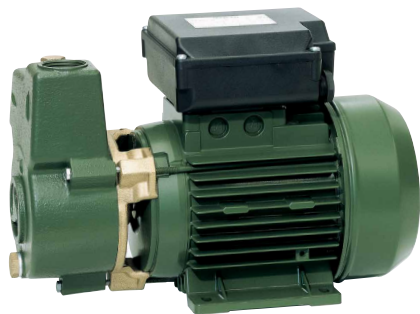

Self-priming peripheral pump with star impeller, with a great suction capacity. Cast iron body with brass ring. Motor support and impeller in brass to avoid the risk of blocking. Driving shaft in stainless steel. Carbon/ceramic mechanical seal.

Asynchronous, closed motor, cooled by external ventilation. Built-in thermal and current overload protection and a capacitor permanently on in the single-phase version. For the protection of the three-phase motor it is advisable to use a suitable overload protection complying with the regulations in force.

**Operating range:** from 8 to 45 l/min. with head up to 53 metres.

**Liquid temperature range:** from -10°C to +80°C from 0°C to +35°C for domestic use.

**Pumped liquid characteristics:** clean, free from solids or abrasive substances, not viscous, not aggressive, not crystallised and chemically neutral.

**Maximum ambient temperature:** +40°C.

**Maximum working pressure:** 10 bar (1000 kPa).

**Protection level:** IP 44 (IP 55 terminal board protection).

**Insulation class:** F.

## TECHNICAL DATA

MODEL	CODE
KPA 40/20 M	101120000
KPA 40/20 T*	60145185

\* NEW IE2 MOTOR

ELECTRICAL DATA						
VOLTAGE 50 Hz	P1 MAX kW	P2 NOMINAL		In A	CAPACITOR	
		KW	HP		µF	Vc
1 x 230 V ~	1,85	0,75	1	4,7	20	450
3 x 230 - 400 V ~	1	0,75	1	3,5-2,1	-	-

## DIMENSIONS AND WEIGHTS

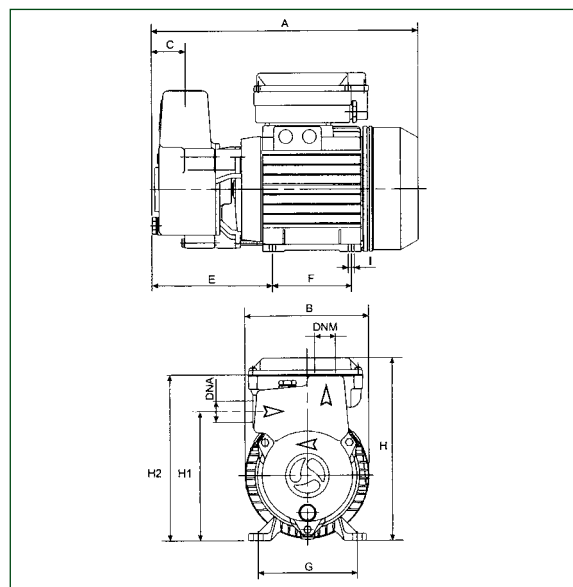
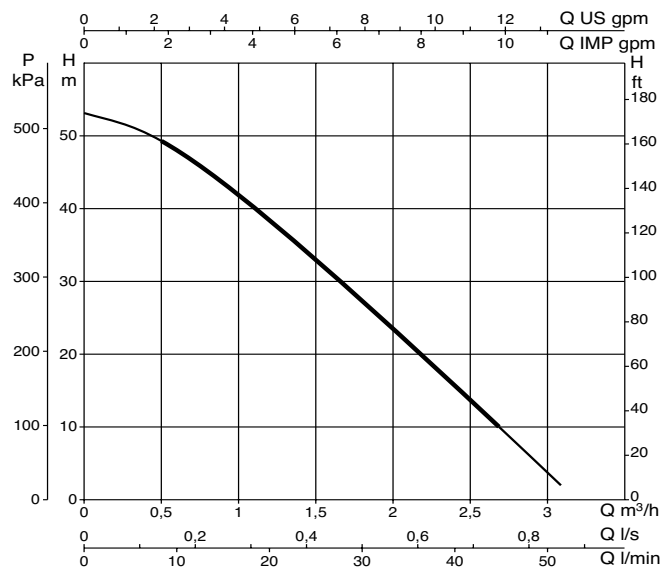

MODEL	A	B	C	E	F	G	IØ	H	HH1	H2	DNA	DNM	PACKAGING DIMENSIONS			WEIGHT KG	Q.TY x PALLET
													L/A	L/B	H		
KPA 40/20	301	142	38	136	90	112	7	206	146	187	1" G	1" G	406	267	402	12,40	39